

**GEMEINWOHL**  
**KLIMA**  
**RESILIENZ**

VON DER KUNST EINES  
GEMEINWOHLORIENTIERTEN  
STÄDTEBAUS

Prof. Dr. Ing. Paola Alfaro-d'Alençon  
Grundlagen der Stadtplanung  
FRA UAS

29/2023

**DFG**

# INHALT

**01**

**# „COMMONS“ (RESSOURCEN,  
AKTEURE UND GOVERNANCE) –  
PRINZIP NACH OSTROM**

**02**

**# INTERNATIONALES THEMA  
KLIMAGERECHTIGKEIT**

**03**

**# ZIELE FÜR NACHHALTIGE  
ENTWICKLUNG & LOKALISIERUNG  
VON SDGs**

#  
VON DER KUNST EINES  
GEMEINWOHLORIENTIERTEN  
STÄDTEBAUS  
Prof. Dr. Ing.  
Paola Alfaro-d'Alençon

**DFG**

Chicago  
Hitzewelle  
1995



Quelle: <https://today.uic.edu/files/2015/07/chicago-heatwave.jpg>

## HEAT TOLL COULD HIT 300

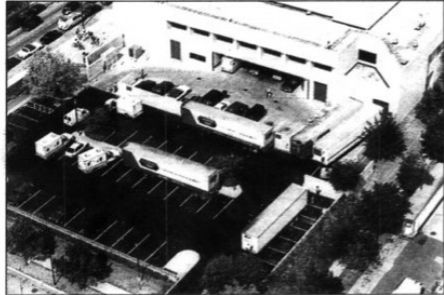

Refrigerated trucks serve as makeshift mortuaries for heat wave victims outside the medical examiner's office Sunday. ABOVE: Workers place another body in a refrigerated truck.

### 116 Die; Few Using City Cooling Centers

By Alex Rodriguez and Mark Brown  
What began as an insufferably unpleasant turn in summer weather has become one of Chicago's worst disasters, claiming 116 lives as of Sunday.  
The toll from the deadly heat wave could reach 300 in Cook County, Medical Examiner Edmund Donoghue said Sunday.  
Most of the deaths involved elderly people, many of whom had heart trouble or other chronic health problems. But the common thread, Donoghue said, was "air conditioning, or lack of it."  
"When temperatures get up into the hundreds, you have to get into air conditioning," Donoghue said. "The body is not used to it."  
Many of those who died had body temperatures of 102 or 103—deadly levels reached after five days of stifling, 90-degree-plus weather, he said.  
The climbing death toll raised questions about what the city can do to protect residents in dangerous weather.  
Mayor Daley defended his administration's plans for dealing with the heat wave.

### RELIEF ON THE WAY TODAY'S FORECAST

Partly sunny, breezy and a bit cooler and less humid today with a high of 85 and a low in the 60s. Tuesday and Wednesday will be even cooler, with highs near 80.

COVERAGE, PAGES 8-11

### County Morgue Trying to Cope

By Tanara Kerrill  
A grim procession of grieving family members, masked technicians and police wagons bearing bodies swarmed Cook County morgue Sunday in the hot, dusty wind.  
The heat wave of '95 left a trail of dead throughout the city. And most of the victims landed at 2121 W. Harrison.  
The Cook County medical examiner's office conducted a record 370 autopsies between 8 a.m. Friday and 3 p.m. Sunday. The morgue's 22 bays were full Sunday, and seven refrigerated tractor-trailers

Ford's New Spin On the Taurus  
AUTOTIMES

IRAQ FREES 2 AMERICANS  
Page 3  
CUBS BEAT CINCINNATI 7-5  
Page 82

Chicago Sun-Times front page from July 17, 1995, reporting numerous deaths from the Heat Wave of '95.

Quelle: <https://99percentinvisible.org/episode/palaces-for-the-people/>



Quelle: <https://www.chicagotribune.com/news/ct-chicago-heat-wave-20-years-later-met-20150715-story.html>

*"Heat Wave really deserves to be on the short list of best non-fiction books about the city."  
—Chicago Magazine*

**Eric Klinenberg**

# HEAT WAVE

A SOCIAL  
AUTOPSY OF  
DISASTER  
IN CHICAGO

SECOND EDITION  
WITH A NEW PREFACE

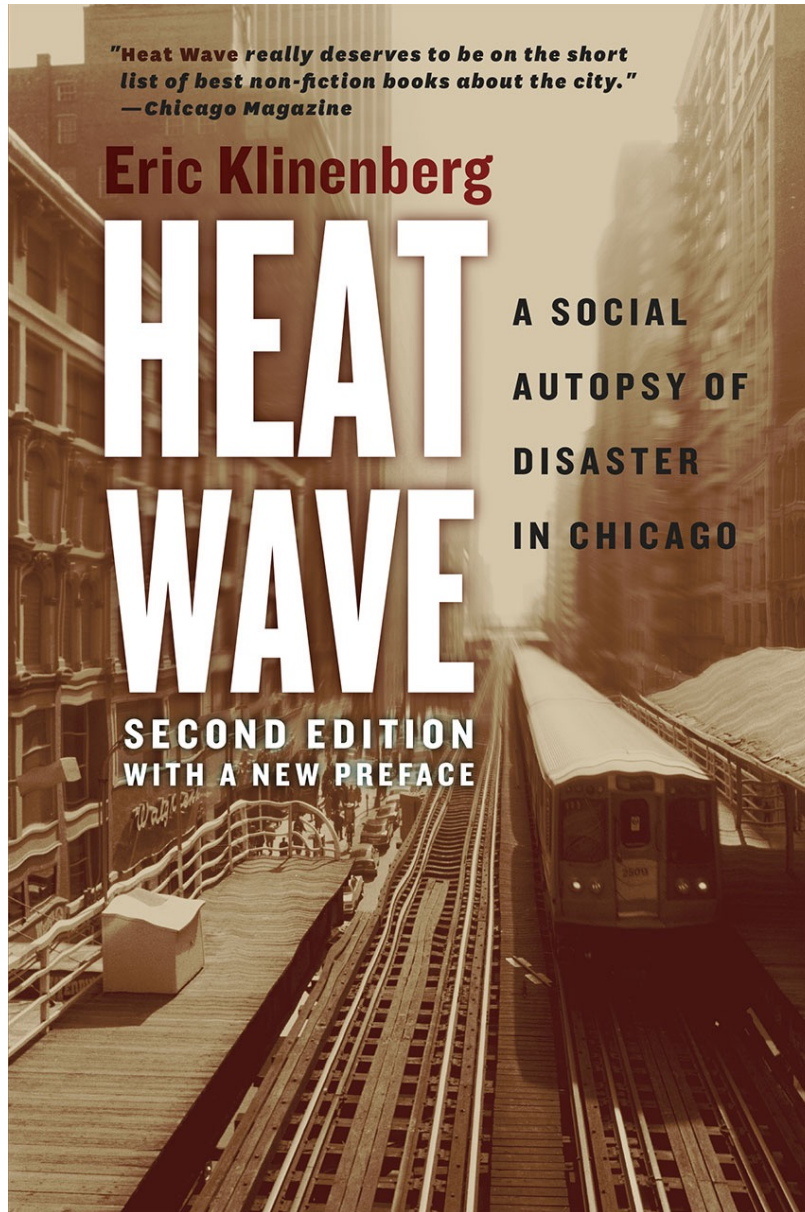

Quelle: <https://press.uchicago.edu/ucp/books/book/chicago/H/bo20809880.html>

**DFG**

# **PALACES FOR THE PEOPLE**

Klinenberg, 2018

**DFG**

# Chicago South Side Pro-Kopf-Einkommen 1989

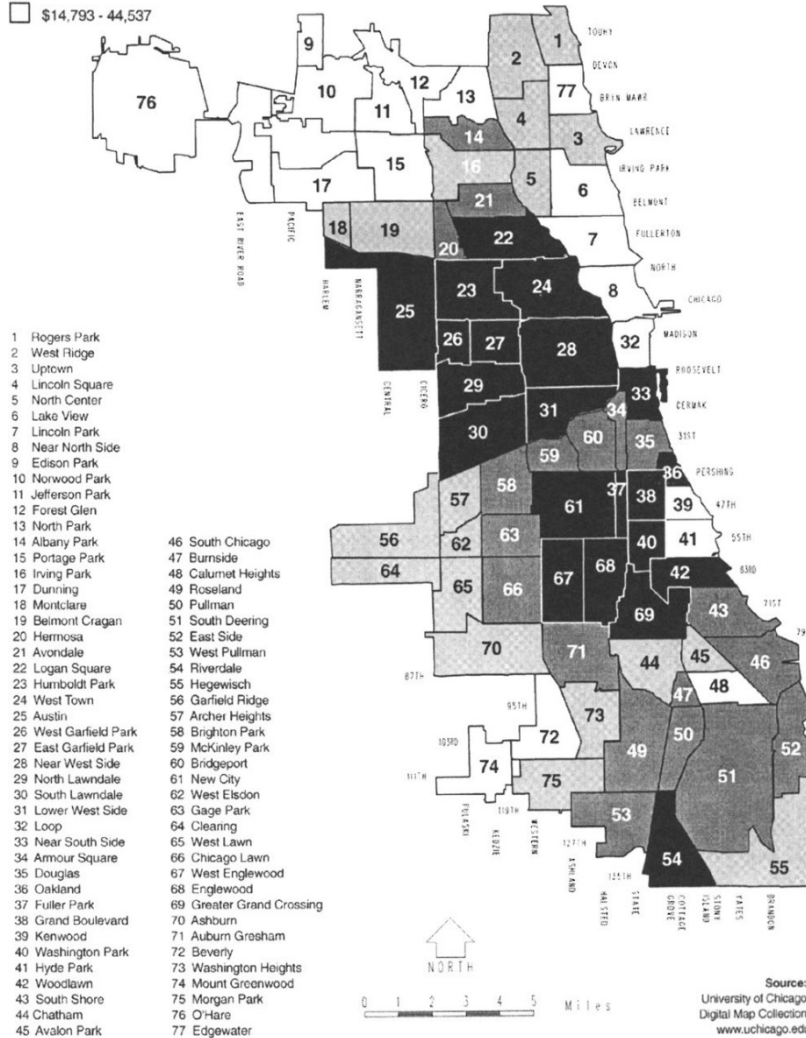
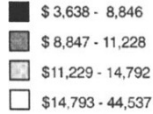

<https://link.springer.com/article/10.1023/A:1006995507723>

# Chicago South Side Anzahl der Hitzetodesfälle 1995

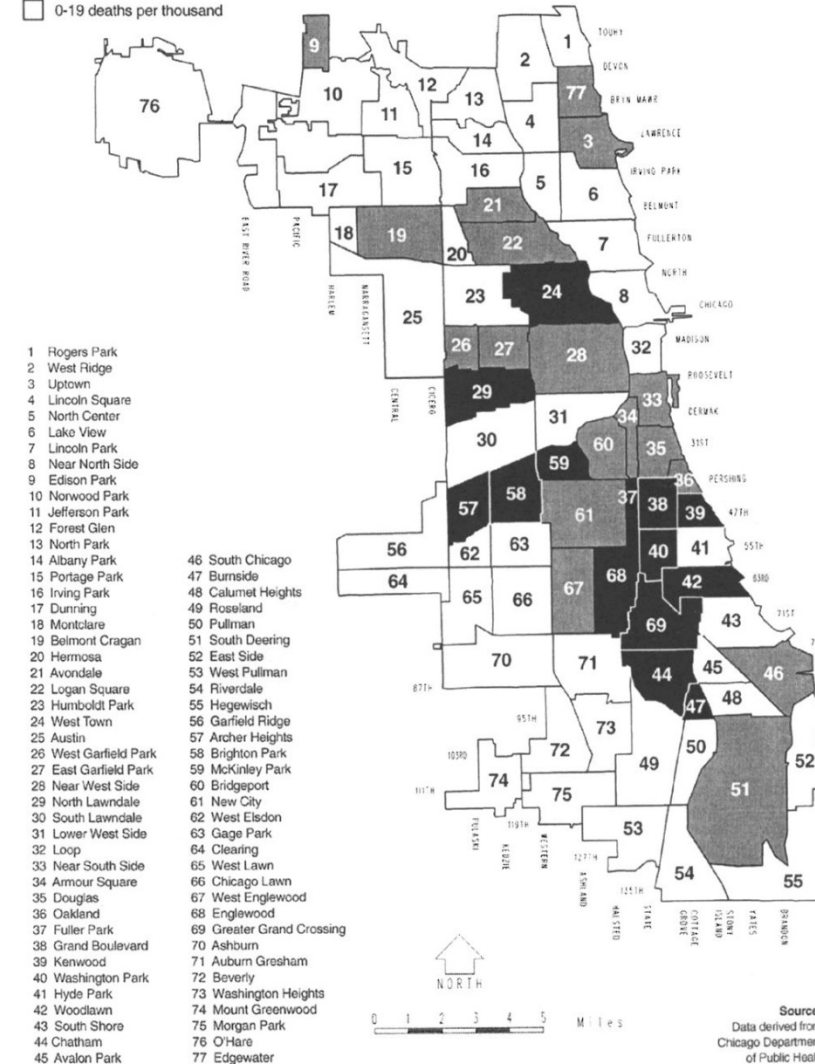
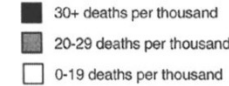

<https://link.springer.com/article/10.1023/A:1006995507723>

# Palaces for the People: How to Build a More Equal and United Society by Eric Klinenberg - review

A US sociologist is eloquent on the importance of creating shared urban spaces - but vague on how to make it happen



▲ Residents clean up the streets in Englewood, Chicago, where abandoned lots have been turned into urban farms. Photograph: Christian Science Monitor/Getty



# COMMONS

Ostrom definiert Commons unter der Voraussetzung folgender Parameter:

- (a) die Existenz einer gemeinsamen oder kollektiven Ressource,**
- (b) die von einer Gemeinschaft geteilt wird,**
- sowie (c) der Prozess, der diese Ressource sichert und reproduziert**

Definition von Commons

**DFG**



## Lina Bo Bardi

SESC Fabrika de Pompéia (Brasil) 1977-1990

“The most important thing is not to know how to build well, but understand how the most of the people live. We had a socialist experiment here”.

# FABRICA DA POMPÉIA – PERFORMATIV UND TEMPORÄR



Quelle: <https://www.brasilwire.com/lina-bo-bardi/>

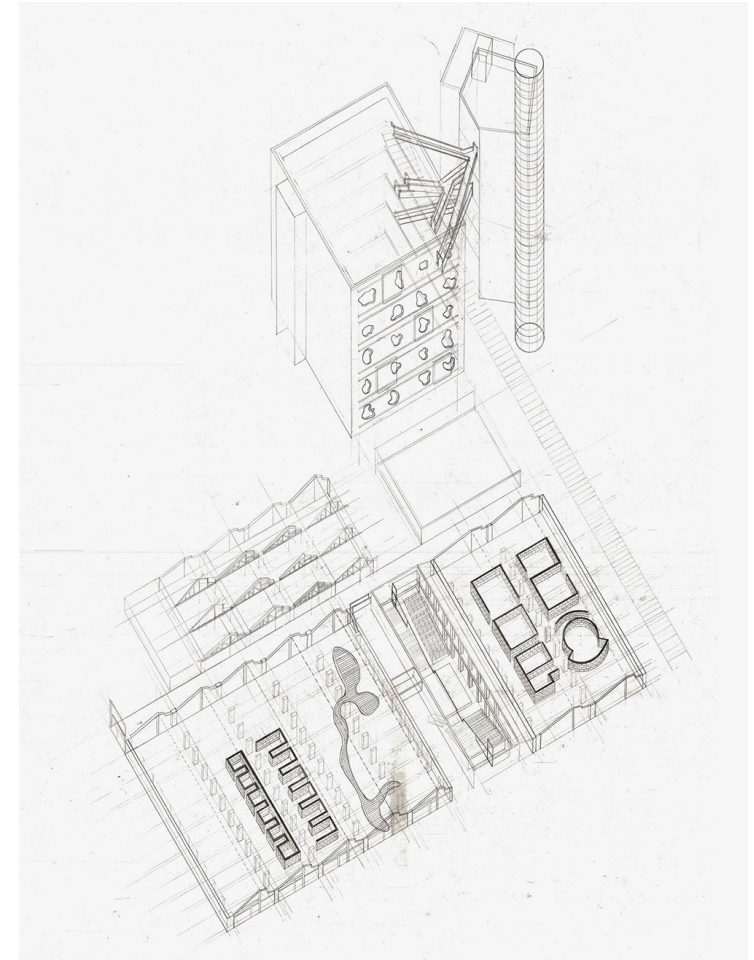

Quelle: <http://www.aashmangoghari.com/prj/css/images/linabo/2.jpg>

**DFG**



Quelle: <https://linaboarditogether.com/2012/08/03/the-making-of-sesc-pompeia-by-marcelo-ferraz/>



Quelle: <https://www.archdaily.com/623834/lina-bo-bardi-together-opens-at-the-graham-foundation>

#  
Kunst und Klima 2020  
COMMONS-CLIMATE-RESILIENCE  
Dr. Ing.  
Paola Alfaro d'Alençon

**DFG**

# **DAS WISSEN ALLER**

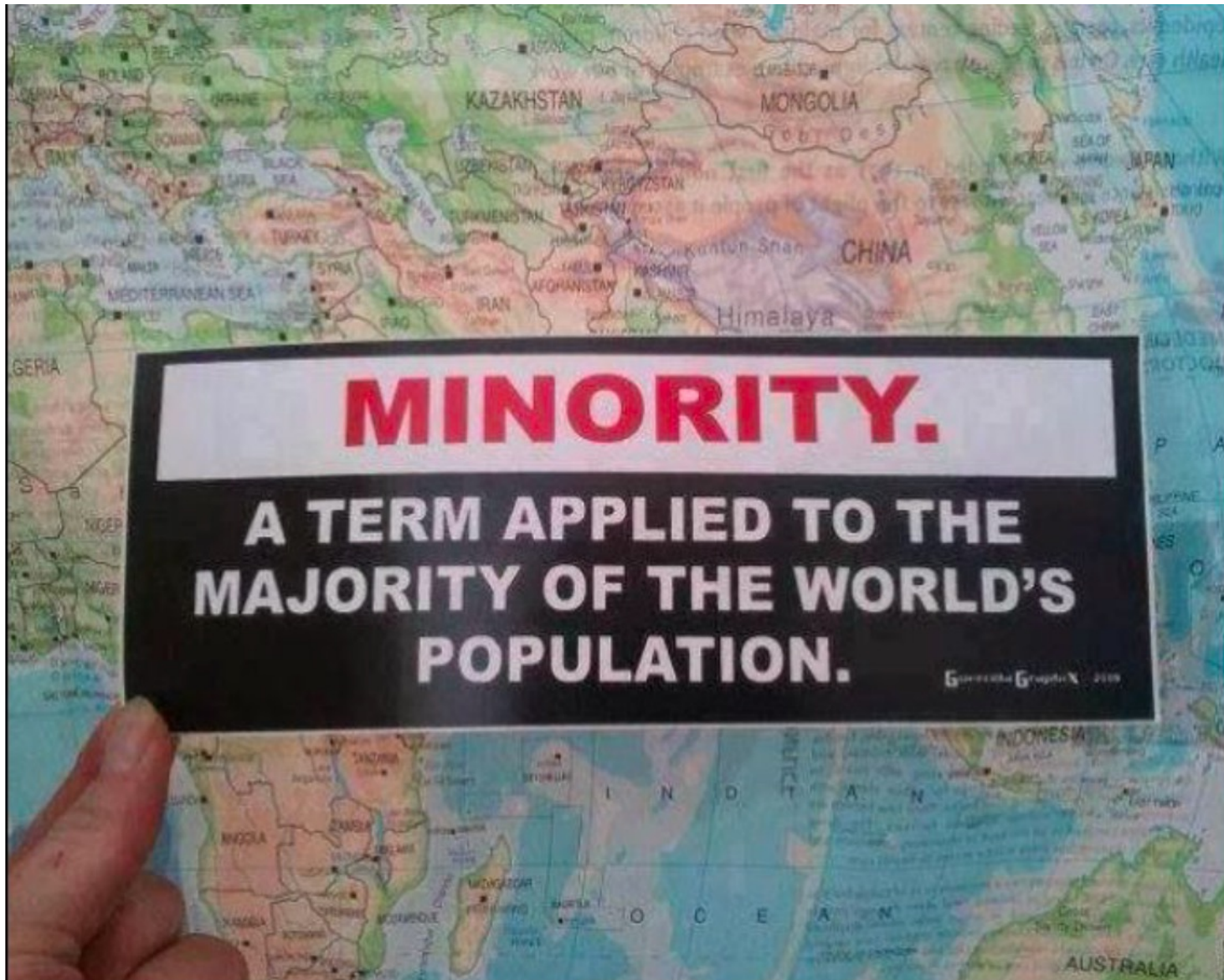

“Majority World”  
Shaidul Alam

Forschungslinien die auffordern post-koloniale Ketten aufzubrechen

- 1990er Jahre entstand der Forschungsauftrag die west-Rethorik zu hinterfragen
- „Majority world“ Shaidul Alam 1990: Wir reden von Minderheiten, dabei stellt es die Mehrheit der Weltbevölkerung dar, die anders lebt als der globale Norden



**“Diseño para el futuro, Sostenibilidad. Innovación y Cultura”**

Quelle: Borreo (2016)

- Lokale Communities zu verstehen mit ihrem lokalen Wissen, als nur was ihnen fehlt (Alam 2008)
  - Multi-Layered Narratives
- Pluralismus in der Wissensbildung um Lösungen aus lokalen Prozesse und Zusammenhänge zu verstehen (Tunstall 2013)



**02**

**#**

**INTERNATIONALES THEMA  
KLIMAGERECHTIGKEIT**

**DFG**



# Internationale Regelwerke

## Agendas...

- Definieren weder ein „Wer“ noch „Wie“, bleiben unverbindlich
- Bieten keine konkreten Richtlinien oder Werkzeuge
- Benötigen Lokalisierungsprozesse, in denen Visionen, transformative Verpflichtungen und Prinzipien der Umsetzung definiert werden

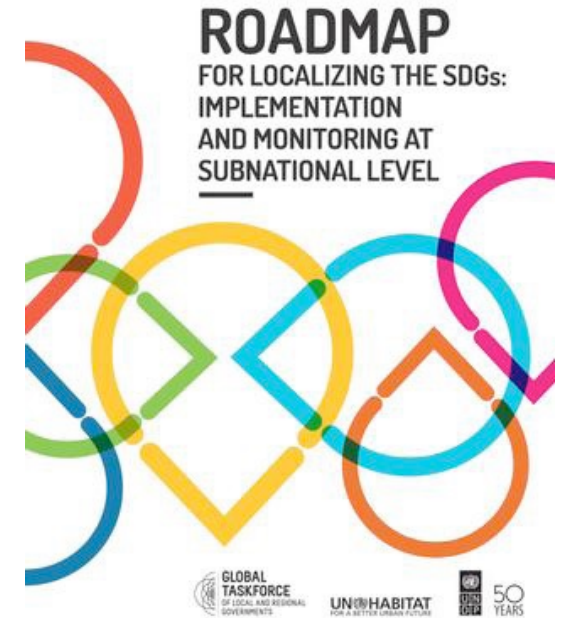
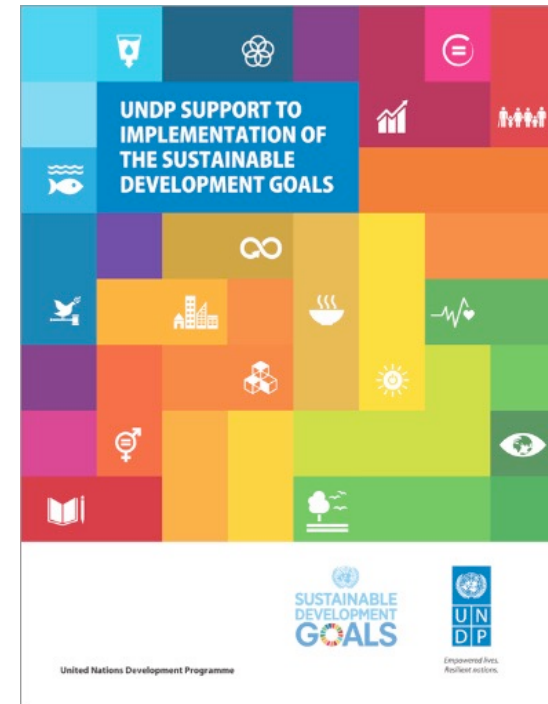
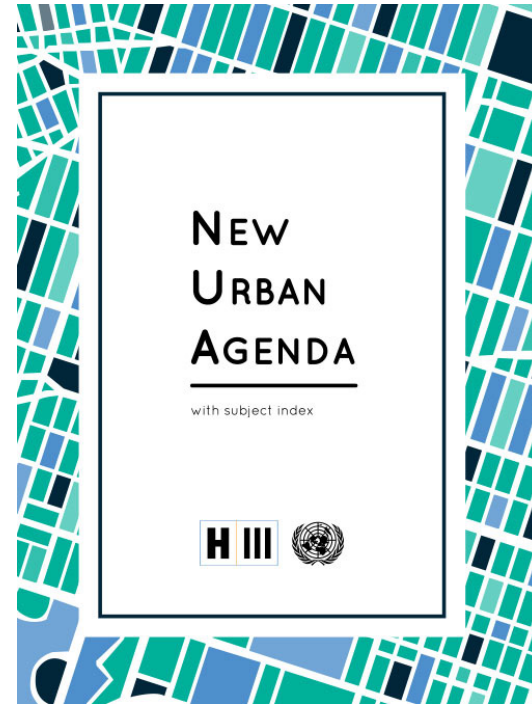

#  
VON DER KUNST EINES  
GEMEINWOHLORIENTIERTEN  
STÄDTEBAUS  
Prof. Dr. Ing.  
Paola Alfaro-d'Alençon

**DFG**

# Grafik 1: Globale Einkommensdezilen und die entsprechenden ökologischen Fußabdrücke

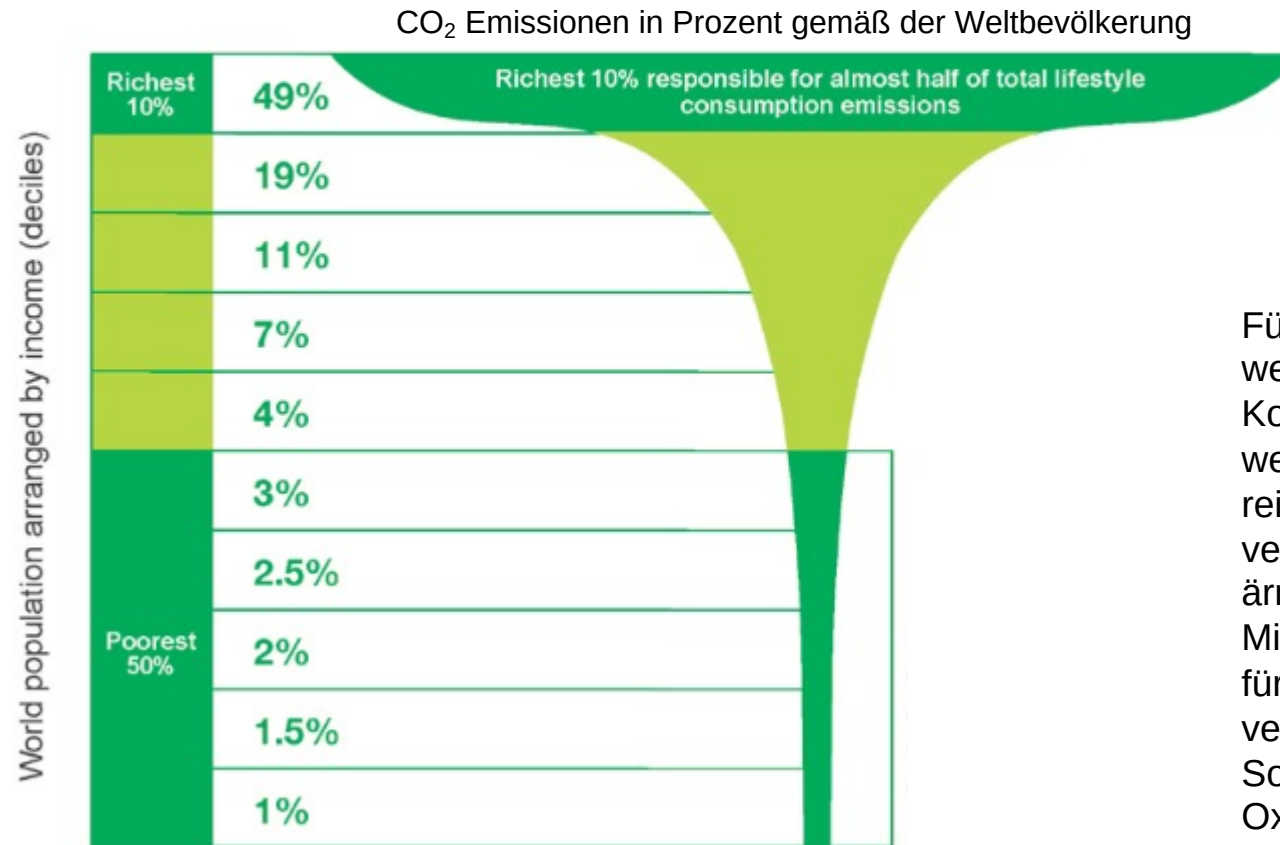

Fünzig Prozent der weltweiten Kohlenstoffemissionen werden von den reichsten 10% verursacht, während die ärmste Hälfte – 3.5 Milliarden Menschen – für lediglich 10% verantwortlich ist. So einer Studie von Oxfam zufolge...

Source: Oxfam

<https://www.weforum.org/agenda/2015/12/richest-10-percent-causing-climate-change>

## Beispiele dafür, wo auf der Welt die ärmste Hälfte der Bevölkerung lebt und der Maßstab ihres ökologischen Fußabdrucks

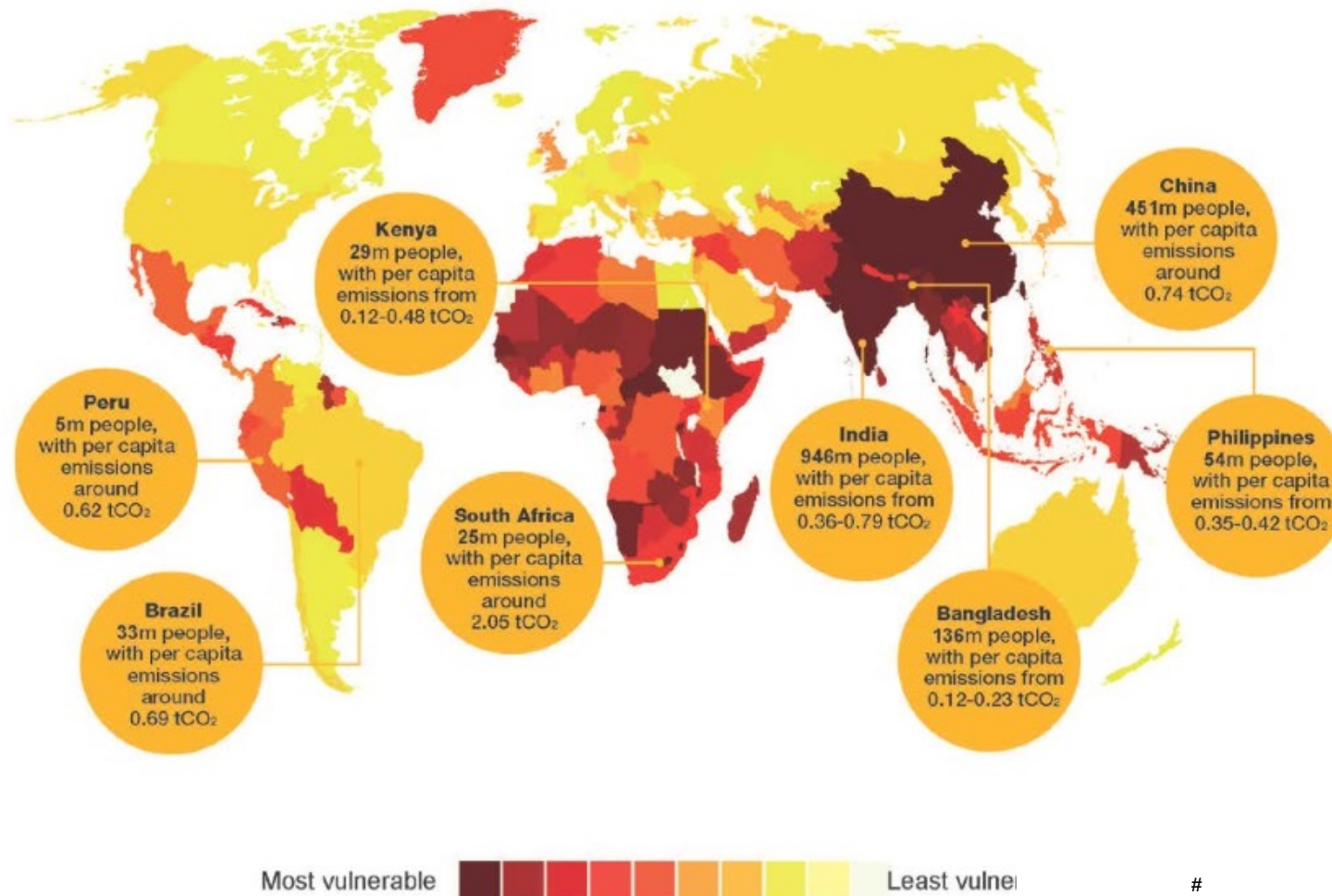

<https://www.weforum.org/agenda/2015/12/richest-10-percent-causing-climate-change>

Die schädigenden Effekte des Klimawandels sind ebenfalls ungleich verteilt um die Welt. Während die starken Einflüsse des Klimawandels global sein werden, sind es die ärmsten (und am wenigsten umweltverschmutzenden) Länder, die am meisten gefährdet sind. Frauen in diesen Regionen, deren Lebensgrundlage oft sehr klimaempfindlich ist, werden am meisten betroffen sein.

#  
VON DER KUNST EINES  
GEMEINWOHLORIENTIERTEN  
STÄDTEBAUS  
Prof. Dr. Ing.  
Paola Alfaro-d'Alençon

**DFG**



Quelle: <https://loeiladelphographie.com/en/daesung-lee-futuristic-archaeology-2/>

## “Futuristic Archaeology”

Mongolia Desert

Ph. Daesung Lee

**DFG**



Quelle: <https://www.daesunglee.com/on-the-shore-of-a-vanishing-island#7>

**“On the shore of a vanishing island”**

Ghoramara/West Bengala/ India

Ph.Daesung Lee

#  
VON DER KUNST EINES  
GEMEINWOHLORIENTIERTEN  
STÄDTEBAUS  
Prof. Dr. Ing.  
Paola Alfaro-d'Alençon

**DFG**



Quelle: <https://www.daesunglee.com/on-the-shore-of-a-vanishing-island#7>

**“On the shore of a vanishing island”**

Ghoramara/West Bengala/ India

Ph.Daesung Lee

#  
VON DER KUNST EINES  
GEMEINWOHLORIENTIERTEN  
STÄDTEBAUS  
Prof. Dr. Ing.  
Paola Alfaro-d'Alençon

**DFG**



**Santiago de Chile**

**DFG**

# UNGLEICHHEITEN UND SOZIALE SEGREGATION

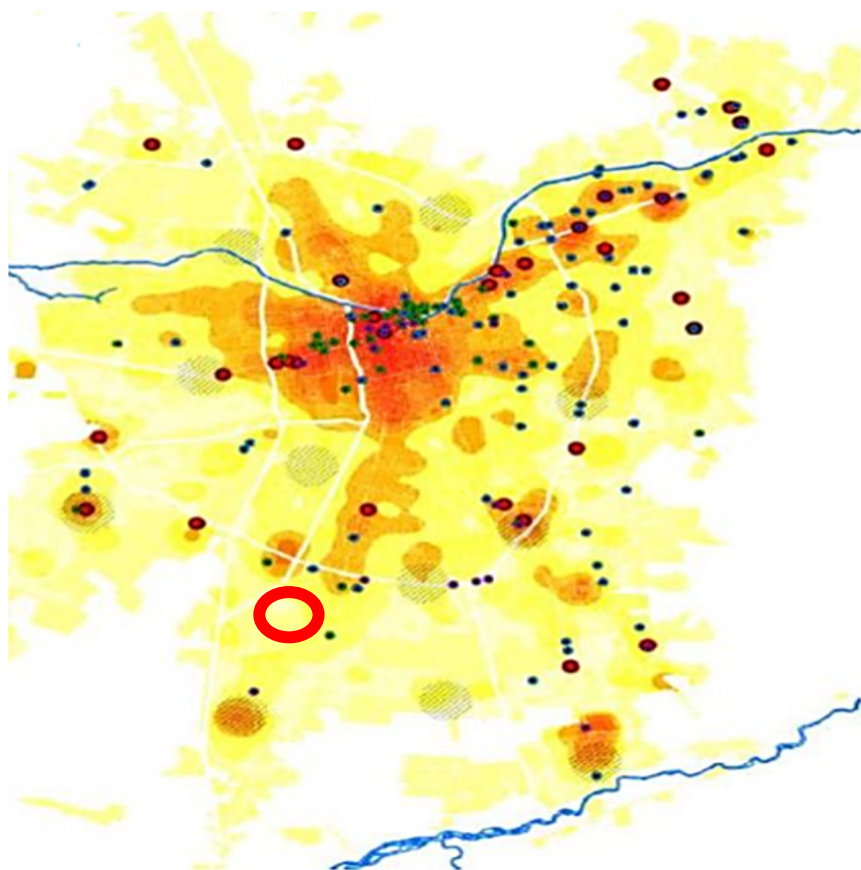

Equipment concentration

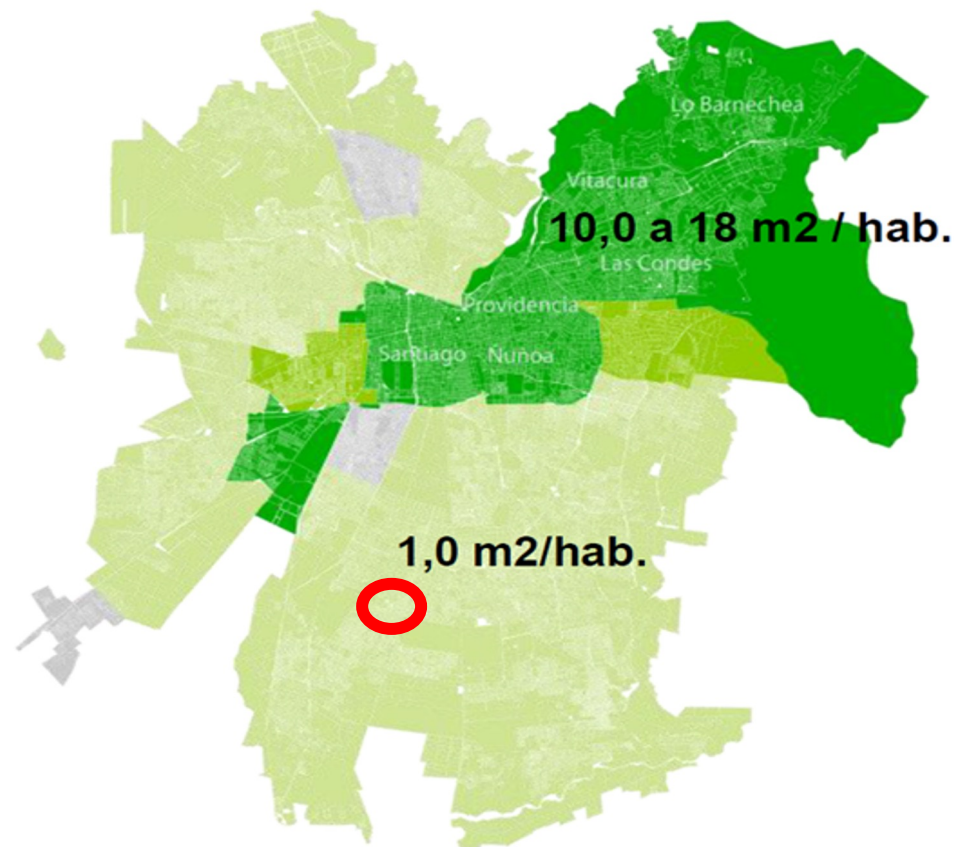

Concentration of green areas



**3**

**#**

**LOKALISIERUNG VON SDGs  
UND DER NEUEN URBANEN AGENDA**

## Wie können SDGs/NUA auf lokaler Ebene umgesetzt werden?

- Stärkung des „urbanen Narrativs“: Anerkennung, dass wir globale sozio-ökologische Probleme nicht ohne Adressierung von Urbanisierungsprozessen thematisieren können
- Erweiterung des konzeptuellen Rahmens um die Stadt nicht nur als Problem- sondern auch als Möglichkeitsraum für weitreichende Strategiewechsel zu sehen
- Definition von Vision, transformativem Einsatz und Prinzipien der Umsetzung



#  
VON DER KUNST EINES  
GEMEINWOHLORIENTIERTEN  
STÄDTEBAUS  
Prof. Dr. Ing.  
Paola Alfaro-d'Alençon

**DFG**

# Status Quo – Agenda Overkill?



Quelle: Alfaro d'Alençon, Misselwitz (2018): Polycentric approaches to the management of urban water resources in South-East Asia

#  
VON DER KUNST EINES  
GEMEINWOHLORIENTIERTEN  
STÄDTEBAUS  
Prof. Dr. Ing.  
Paola Alfaro-d'Alençon

**DFG**



Quelle: [https://en.wikipedia.org/wiki/Sustainable\\_Development\\_Goals](https://en.wikipedia.org/wiki/Sustainable_Development_Goals)

**DFG**

# Test 1: Nachhaltigkeitsspiegel und Bilanz der Strategiewirksamkeit

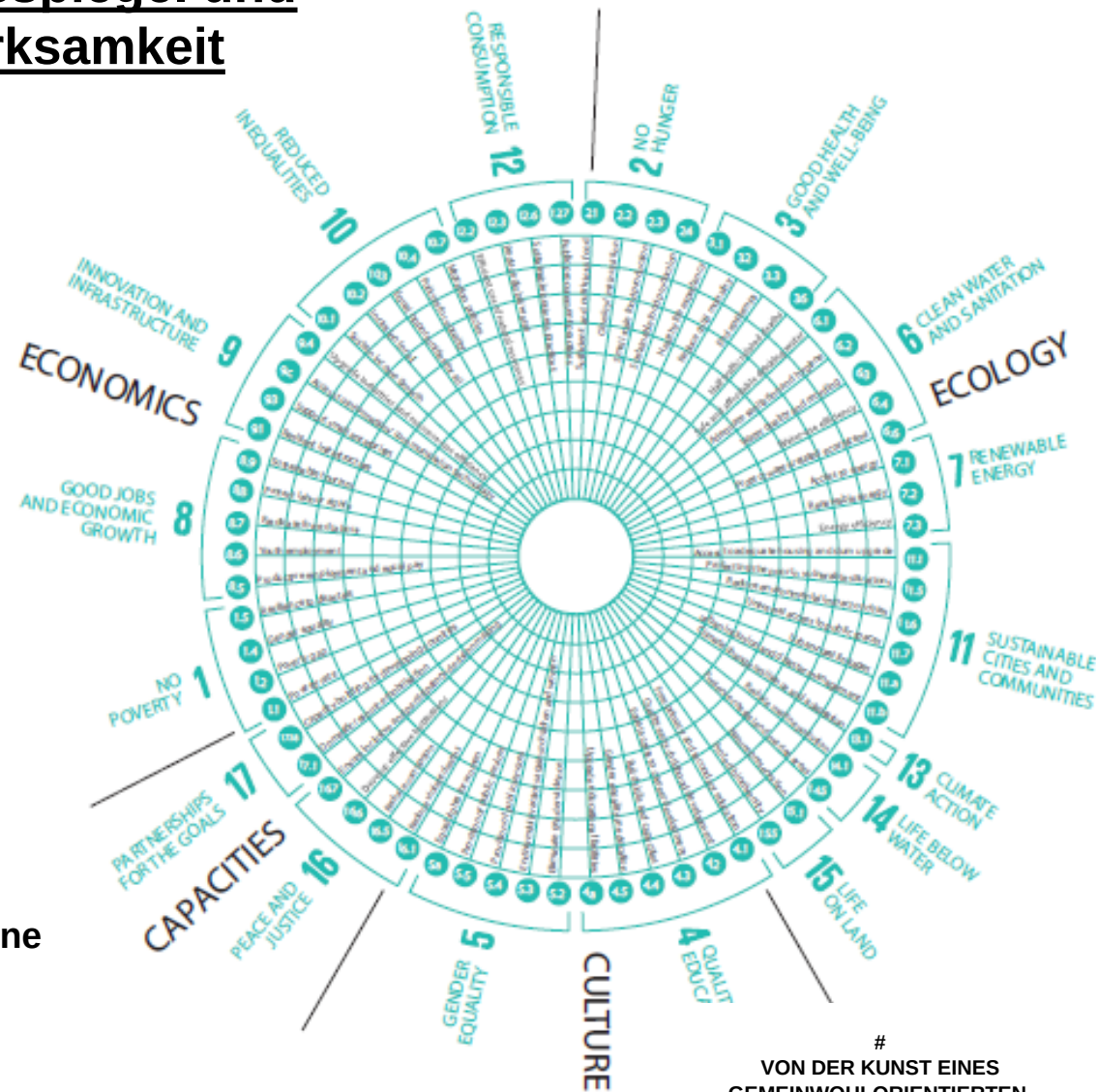

Frage 1: Wie können SDGs/NUA auf lokaler Ebene umgesetzt werden?

#  
 VON DER KUNST EINES  
 GEMEINWOHLORIENTIERTEN  
 STÄDTEBAUS  
 Prof. Dr. Ing.  
 Paola Alfaro-d'Alençon



## Test 1: Nachhaltigkeitsspiegel und Bilanz der Strategiewirksamkeit



WUF 2018

**DFG**



#  
VON DER KUNST EINES  
GEMEINWOHLORIENTIERTEN  
STÄDTEBAUS  
Prof. Dr. Ing.  
Paola Alfaro-d'Alençon

**DFG**



**BRAZIL**  
Sao Paulo  
PARAISOPOLIS

Quelle: <https://www.lafargeholcim-foundation.org/projects/urban-remediation-and-civic-infrastructure-hub>

**DFG**





Quelle: <https://www.lafargeholcim-foundation.org/projects/urban-remediation-and-civic-infrastructure-hub>



#  
VON DER KUNST EINES  
GEMEINWOHLORIENTIERTEN  
STÄDTEBAUS  
Prof. Dr. Ing.  
Paola Alfaro-d'Alençon

**DFG**



**Architect:**  
Urban-Think Tank  
Alfredo Brillembourg & Hubert Kumpner

**Project Architects:**  
Michael Contento & Lindsey Sherman

**Project Team:**  
Mario Augusto Bueno, Carlos Guimaraes

**Acoustic Engineer:**  
Dr. Eckard Mommertz  
Mueller-BBM International GmbH

**Sustainability Engineer:**  
Thomas Auer, Daniel Pianka  
Transsolar

**Water Engineer:**  
Eric Rothstein, Ian Lipsy  
eDesign Dynamics

**Structural Engineer:**  
Holger Tschern  
Imagine Structure

**Envelope Engineer:**  
Marcel Bilow  
Imagine Envelope

- 1 Playing Field
- 2 Public elevator; Access to all levels of the site
- 3 Bus Stop and turnaround
- 4 Handicap accessible public ramp
- 5 New terrace system
- 6 Urban agriculture
- 7 Terrace/Play space
- 8 Seating for outdoor public events and sports
- 9 Terrace connections to existing pathways; Re-integration of fragmented context
- 10 Existing pathways
- 11 Auxiliary Community Center

**Brazil**  
Population: 187 Million  
Geographic Area: 8,547,408 km<sup>2</sup>  
Urban Population: 80% of Total

**São Paulo**  
Population: 10.5 Million  
Metropolitan Region: 19.7 Million  
Geographic Area: 1,523 km<sup>2</sup>

**Paraisópolis:**  
Population: 80,000  
Geographic Area: 822,739 m<sup>2</sup>  
Occupation Date: 1960s  
No. of Lots: 9,236  
No. of Properties: 17,141  
Residential: 14,538  
Other: 2,603



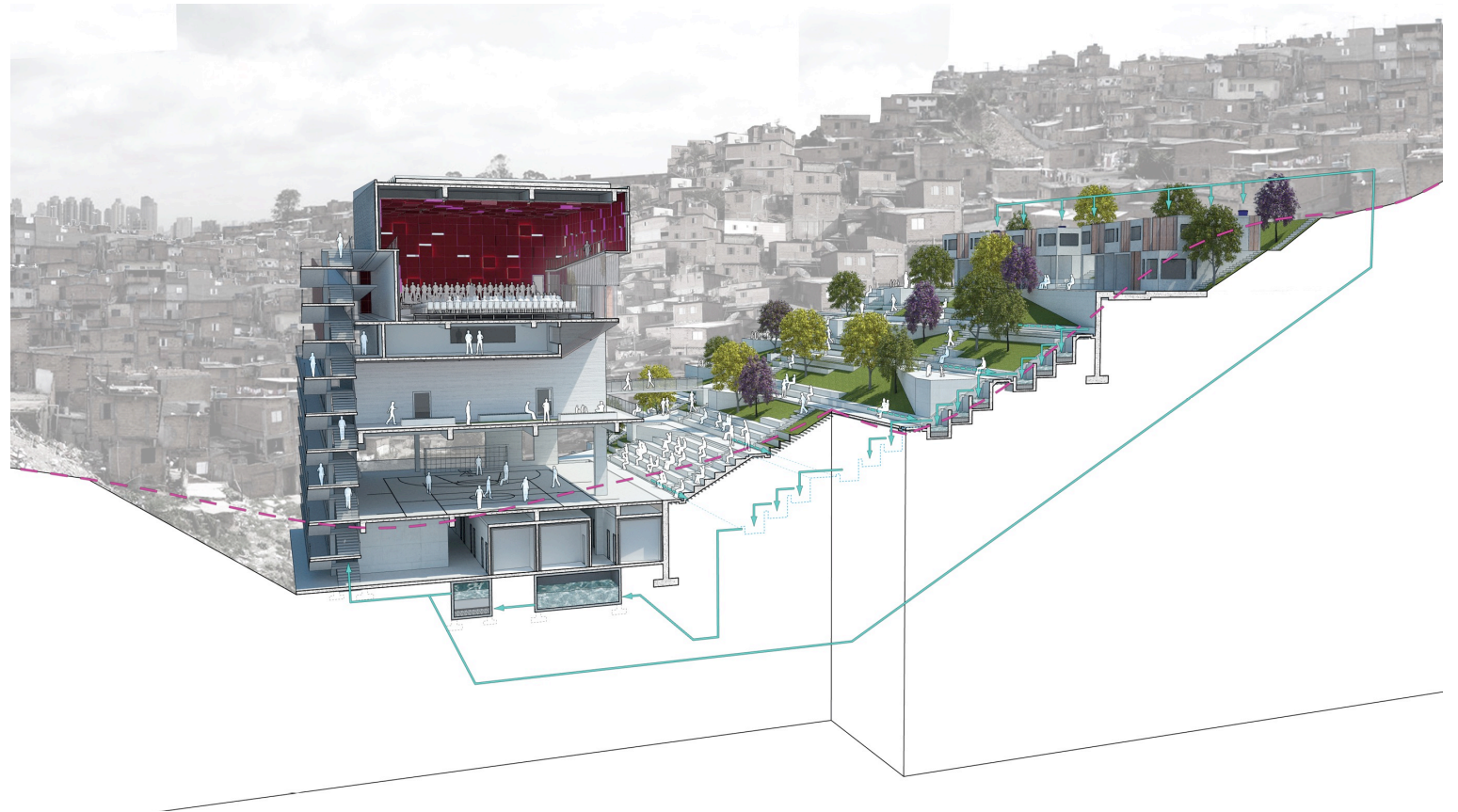

Quelle: <https://www.lafargeholcim-foundation.org/projects/urban-remediation-and-civic-infrastructure-hub>

#  
Kunst und Klima 2020  
COMMONS-CLIMATE-RESILIENCE  
Dr. Ing.  
Paola Alfaro d'Alençon

**DFG**



Quelle: <https://www.lafargeholcim-foundation.org/projects/urban-remediation-and-civic-infrastructure-hub>

**DFG**



**USA**  
NEW YORK CITY  
REBUILD  
BY DESIGN

Quelle: <https://www.starrwhitehouse.com/project/rebuild-by-design/>

**DFG**

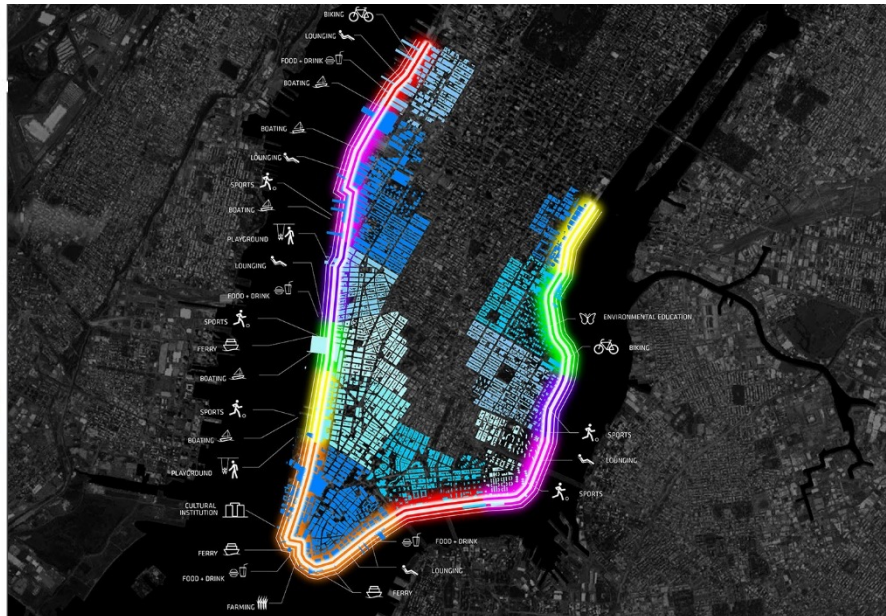
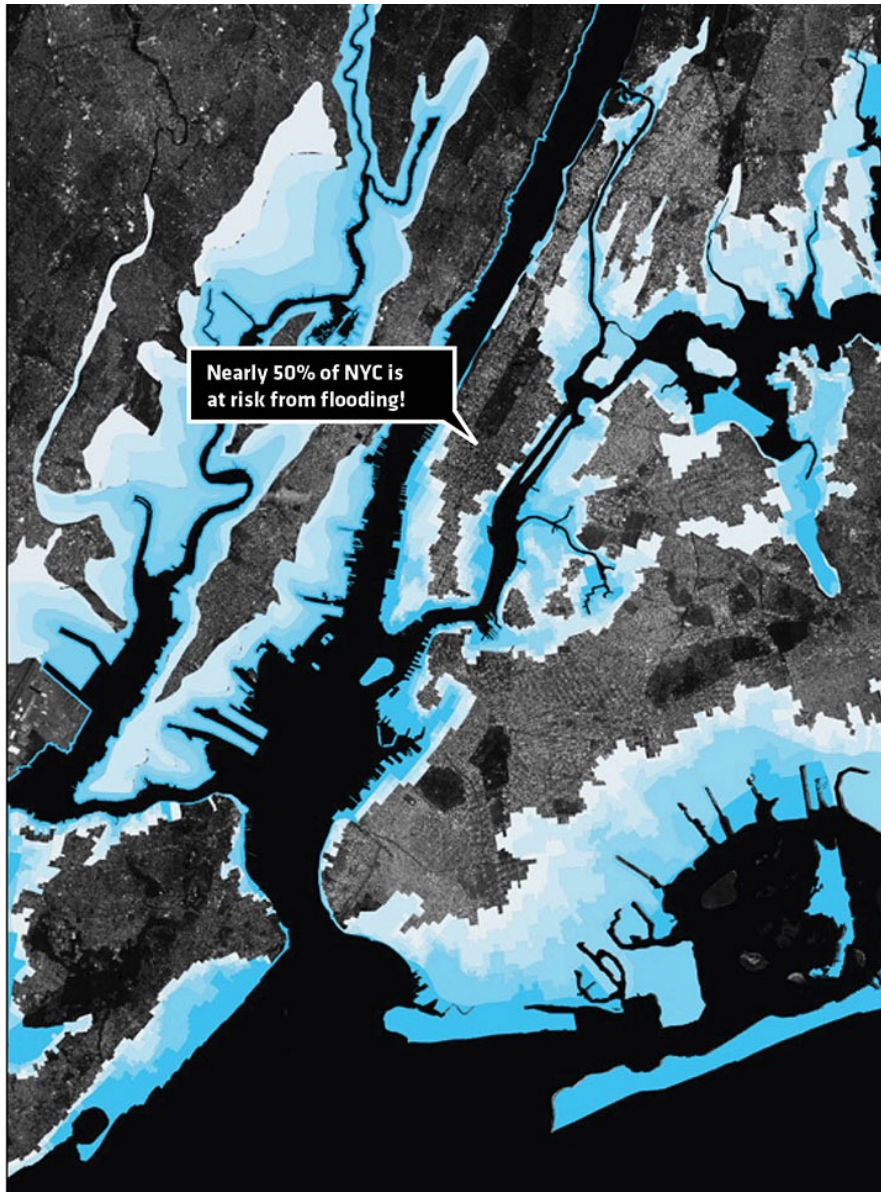

Quelle: <https://www.starrwhitehouse.com/project/rebuild-by-design/>

**DFG**

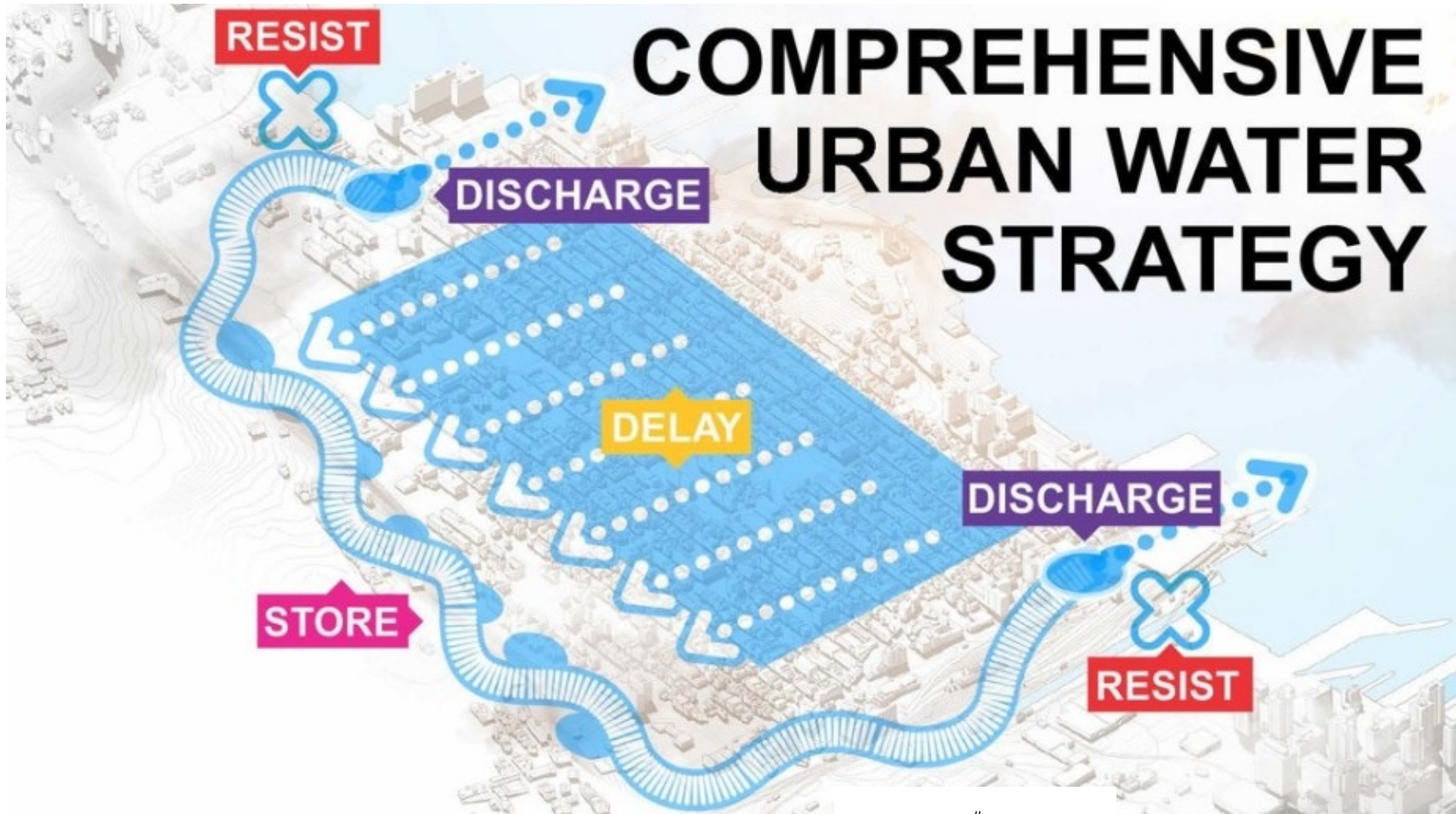

Quelle: <http://www.rebuildbydesign.org/data/images/819/events-7-28-16-2-.jpg>

#  
VON DER KUNST EINES  
GEMEINWOHLORIENTIERTEN  
STÄDTEBAUS  
Prof. Dr. Ing.  
Paola Alfaro-d'Alençon

**DFG**



**RESIST** 



**DFG**







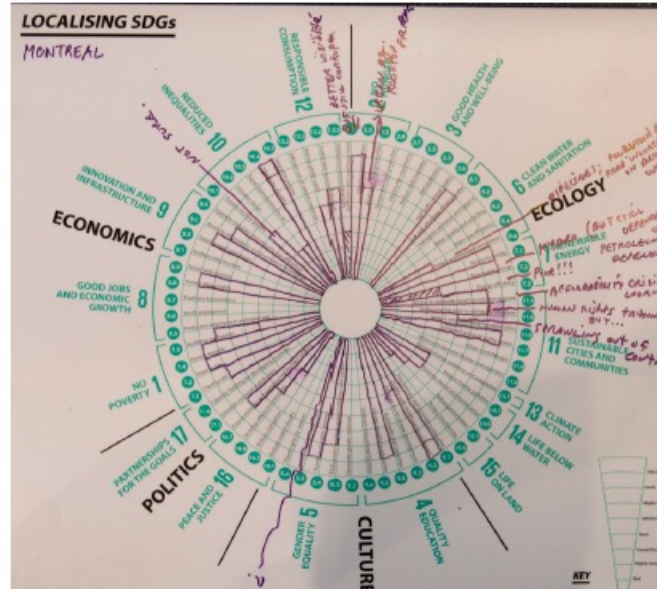
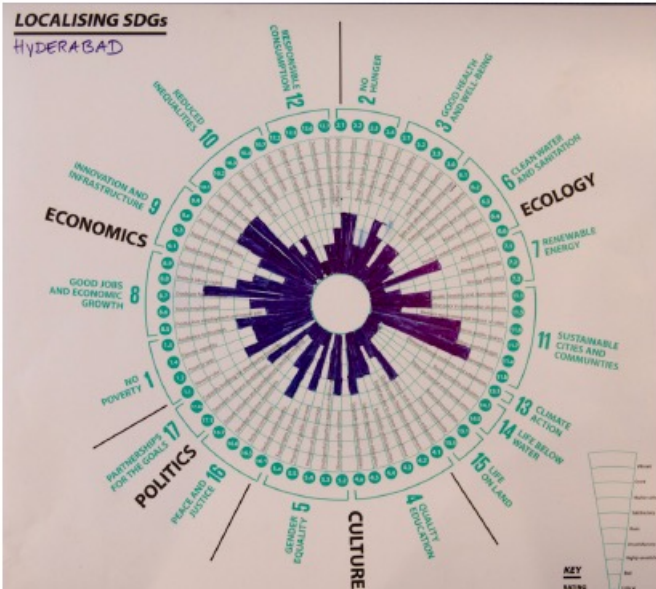
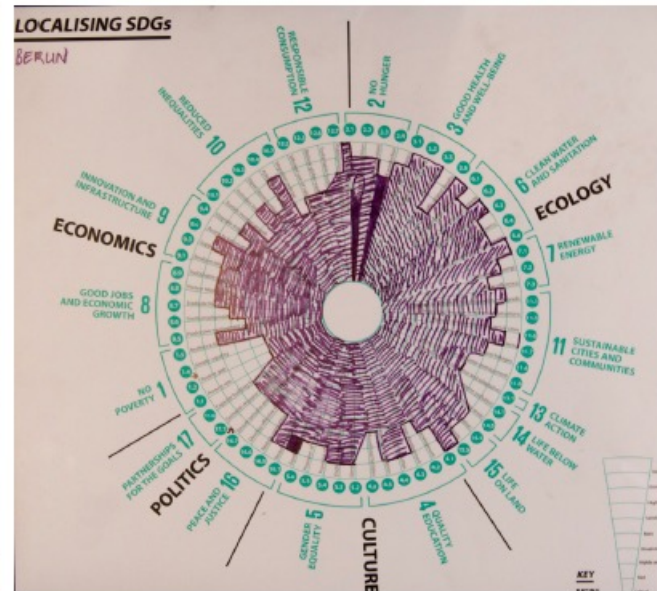
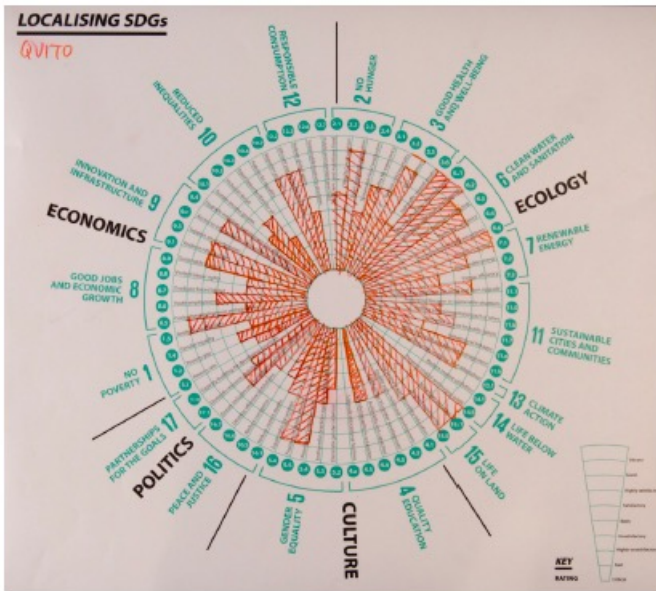
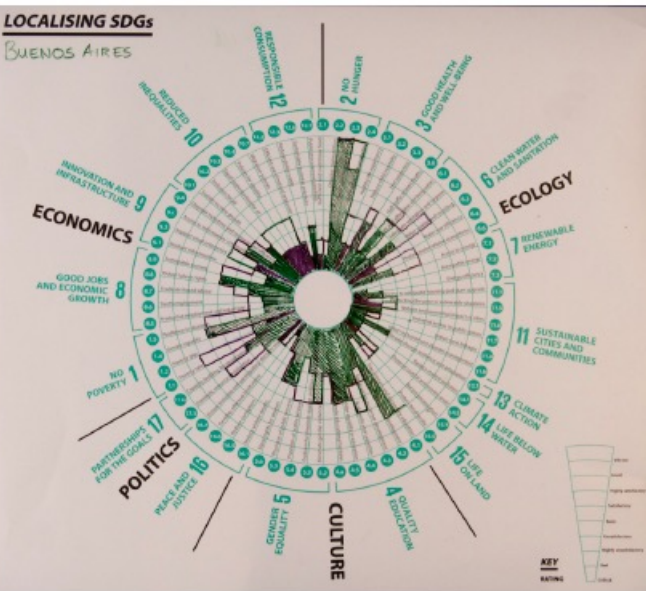

**DFG**



CO-DESIGN APPROACH

-  city
-  district
-  neighbourhood
-  urban block

COMPREHENSIVE URBAN WATER STRATEGY

RECOVERY of SOCIO-ECOLOGICAL CONDITIONS

IMPROVEMENT ARCHITECTURAL QUALITY OF SPACES

Source: Alfaro d'Alençon, Misselwitz (2018): Polycentric approaches to the management of urban water resources in South-East Asia



# INTEGRIERTE, INTERSEKTORALE UND POLYZENTRISCHE ANSÄTZE

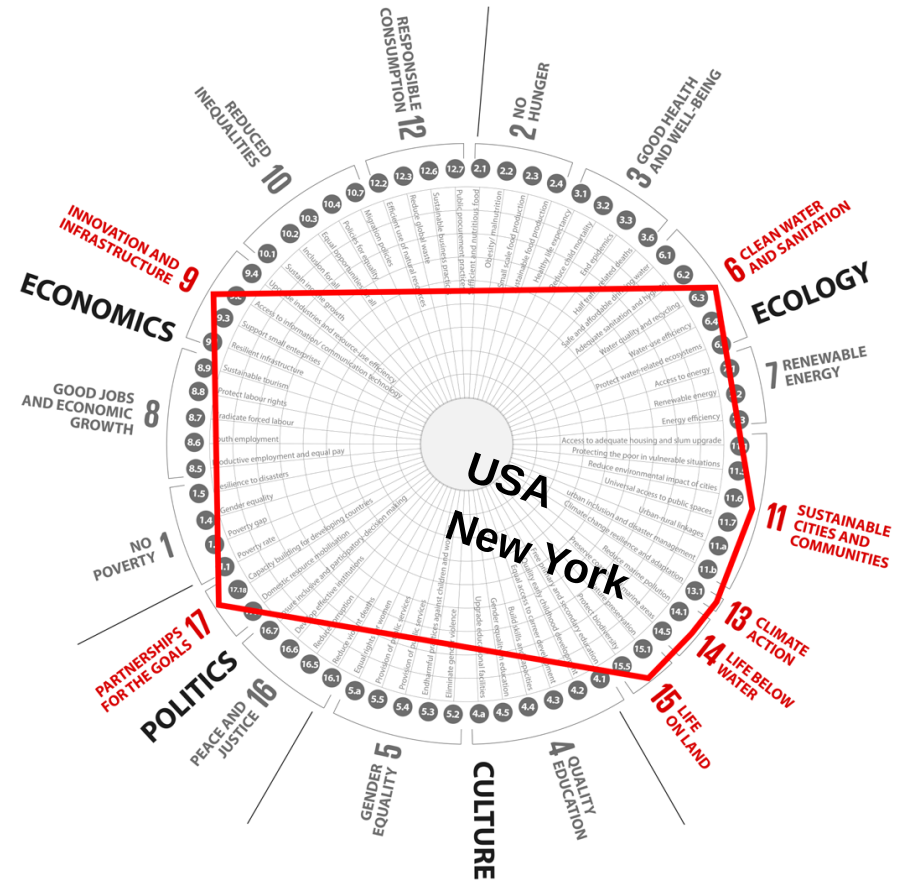

Source: Alfaro d'Alençon, Misselwitz (2018): Polycentric approaches to the management of urban water resources in South-East Asia

#  
Kunst und Klima 2020  
COMMONS-CLIMATE-RESILIENCE  
Dr. Ing.  
Paola Alfaro d'Alençon



# INTEGRIERTE, INTERSEKTORALE UND POLYZENTRISCHE ANSÄTZE

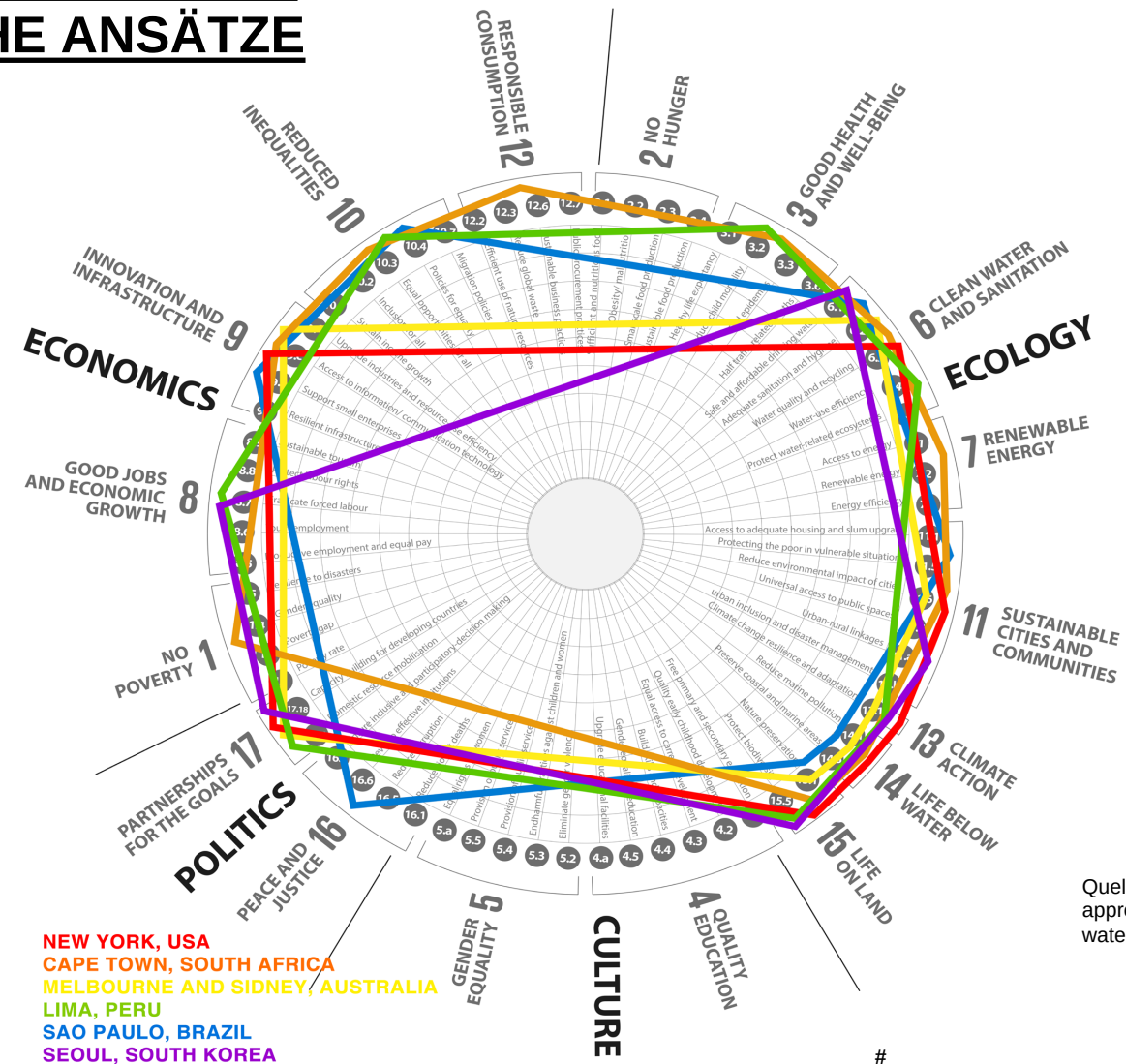

Quelle: Alfaro d'Alençon, Misselwitz (2018): Polycentric approaches to the management of urban water resources in South-East Asia

Wie können SDGs/NUA  
auf lokaler Ebene  
umgesetzt werden?

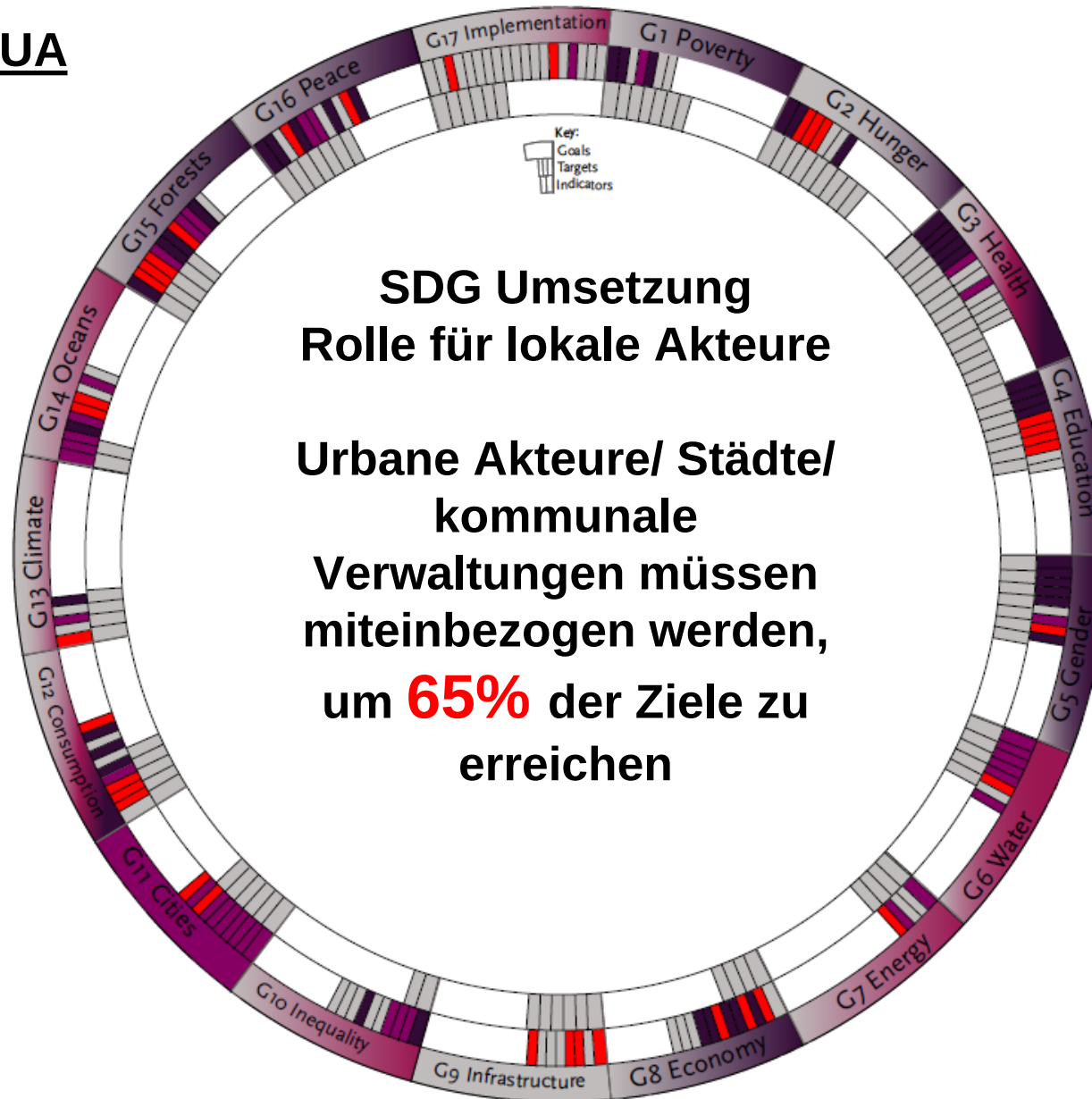

Quelle: Alfaro d'Alençon, Misselwitz (2018): Polycentric approaches to the management of urban water resources in South-East Asia

# DISKURS URBANE RESILIENZ

MULTIDISZIPLINÄRE PERSPEKTIVE

MULTISKALARER PROZESS

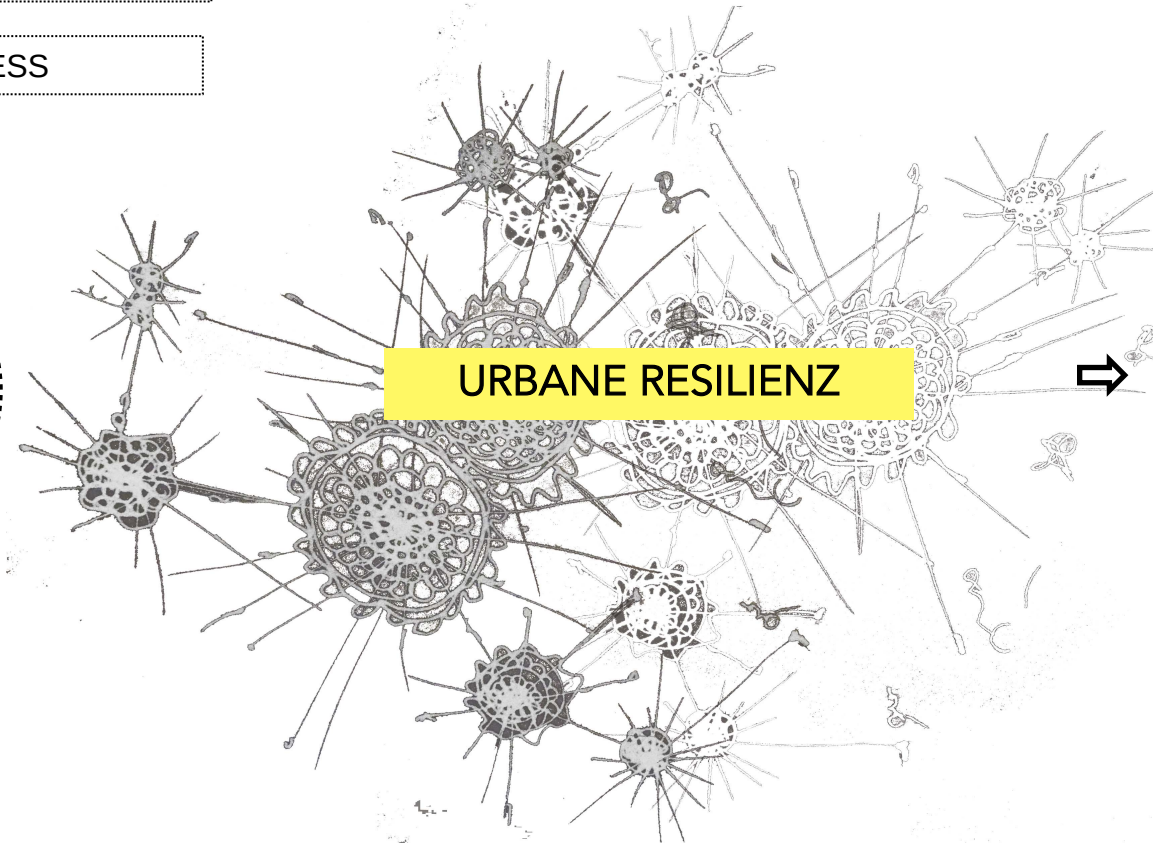
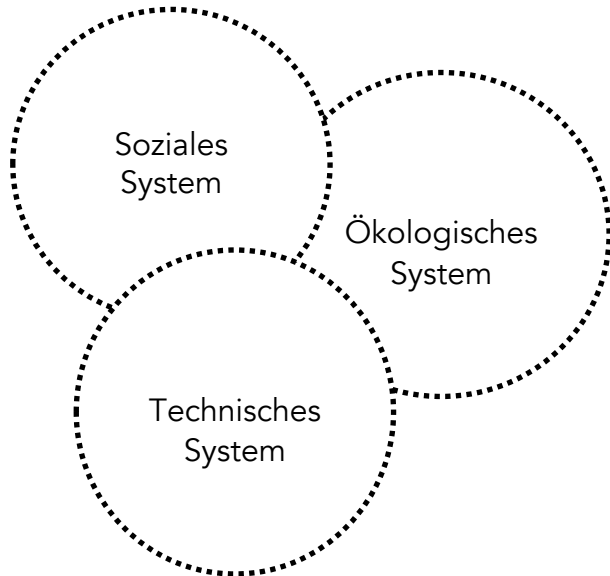

## CHARAKTERISTIKA URBANER RESILIENZ

Systemische Herangehensweise

Ökologische and soziale Diversität

Adaptives Design

Modularität

Flexibilität

Multiskalare Netzwerke und Verbindungen

-  regional
-  city
-  district
-  neighbourhood
-  urban block
-  building



**GEMEINWOHL**  
**KLIMA**  
**RESILIENZ**

VON DER KUNST EINES  
GEMEINWOHLORIENTIERTEN  
STÄDTEBAUS

Prof. Dr. Ing. Paola Alfaro-d'Alençon  
Grundlagen der Stadtplanung  
FRA UAS

29/2023

**DFG**